

What Is A Safety Knife?

ARK-B7



- Easy open
- Ultra light weight engineering grade plastic body
- Comes with 5 extra blades within the knife
- Equipped with a metal wear strip for heavy use
- Two possible blade extension lengths

A safety knife is a spring-loaded, self-retracting utility knife that is used to more safely open boxes and cartons.

Allway safety knives radically reduce the incidence of minor accidents.

Allway safety knives are easy to use with either hand, and the rounded point blades virtually eliminate puncture wounds.

Note: Allway safety knives all use the KBS round point safety blade.

Allway Safety Knife Usage

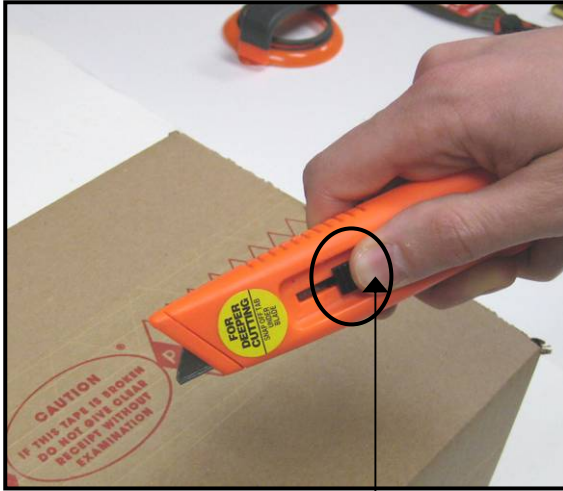

The thumb pushes the button forward, and the blade is ready to cut.

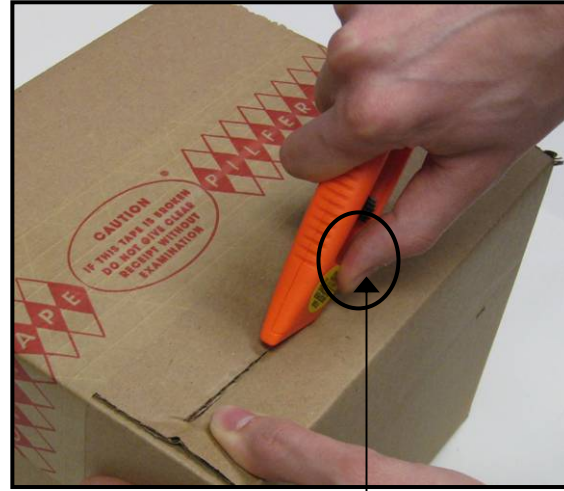

While cutting, the thumb is released. The blade remains engaged and continues to cut, held in place by the friction created by the box.



The blade retracts automatically when the knife extends beyond the box, drastically reducing injuries.

ARK-B7 Safety Knife:

When cutting with the ARK-B7 self-retracting safety knife, the user doesn't need to maintain pressure on the slider with his or her thumb.

When the rounded-point knife blade completes the cut, the blade will retract automatically, and this drastically reduces the incidence of cuts.

The rounded point also reduces the severity of puncture wounds.

Additionally, the ARK-B7 is usable by both right- and left-handed workers.

Left and Right Hand Usage

ARK-B7

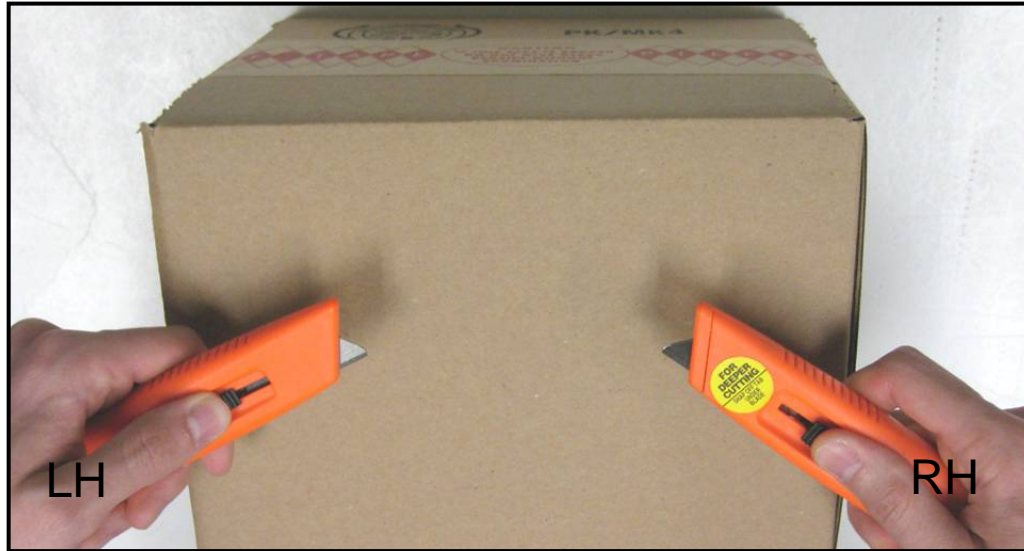

The ARK-B7 is designed for both left- and right-handed workers.

Easy Open and Extra Blade Storage

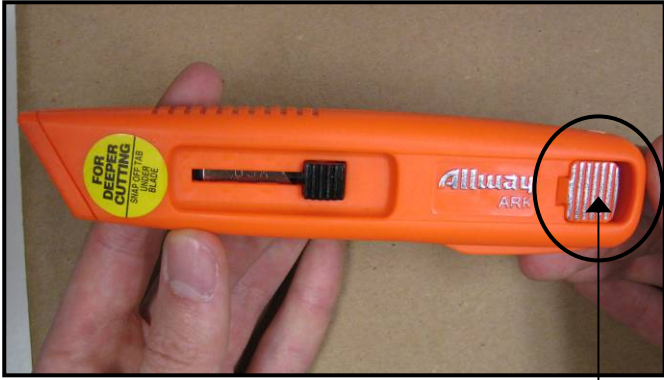

Depress the button.

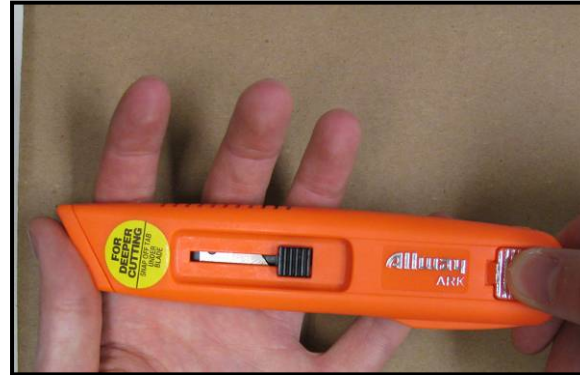

Make sure you are not holding the body closed.



The knife opens and you gain access to the spare blades inside.

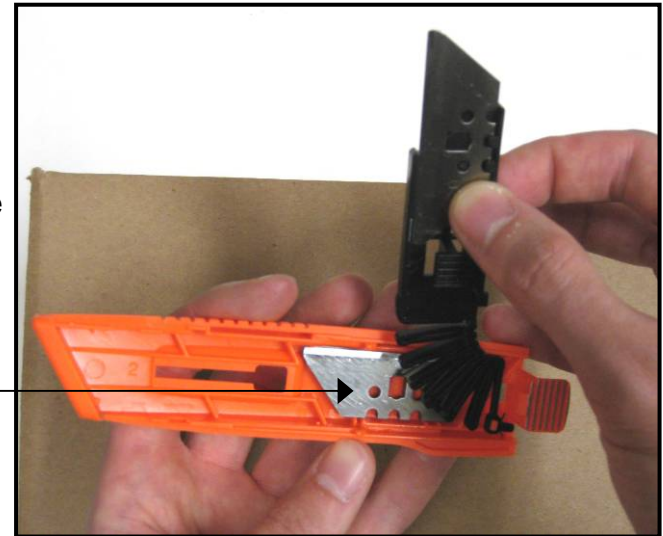

Within the knife body is space to store extra blades.
The ARK-B7 ships with 1 blade on the slider and 5 extra blades within the knife.

Deeper Cutting with the ARK-B7

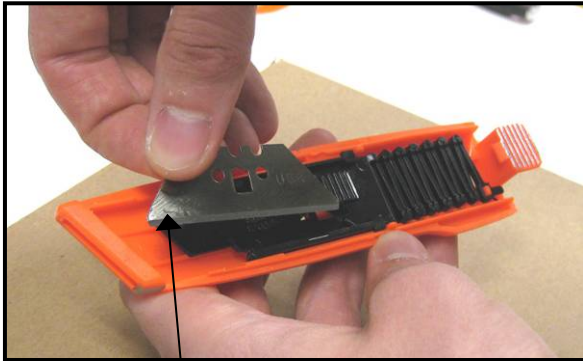

After opening the knife, remove the blade from the slider.

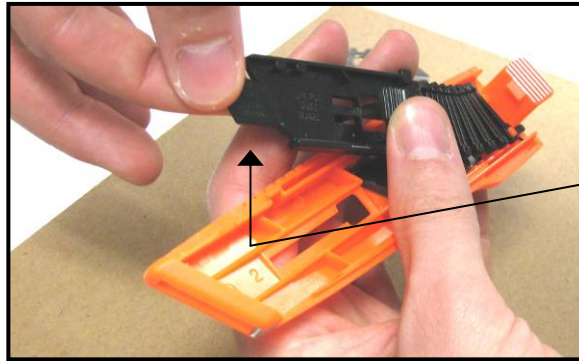

Bend the tab on the front of the slider back and forth several times.

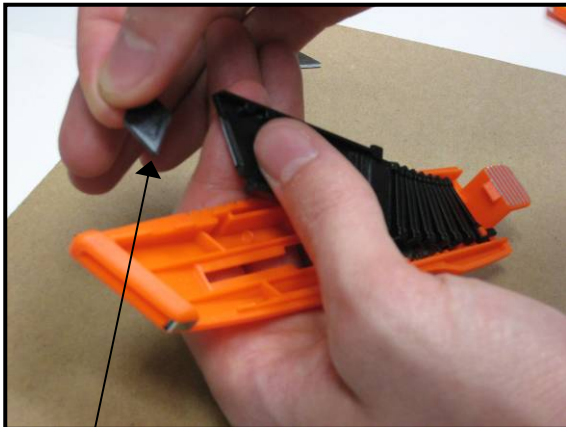

The tab is now removed.

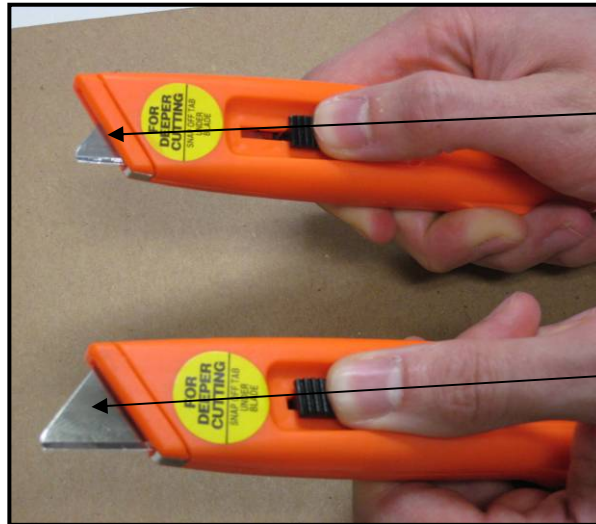

Original, maximum blade extension.

New, maximum blade extension.

The ARK-B7 is also available with the deeper cutting feature disabled.

Metal Wear Strip for Heavy Use

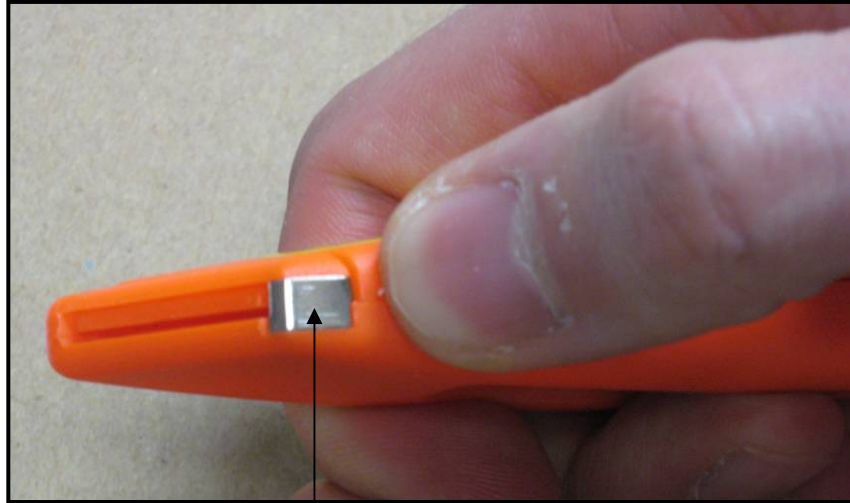

The metal wear strip on the bottom portion of the front end of the ARK-B7 means that the knife won't wear out even with **very** heavy usage.